



# RHINO-RACK

Aerodynamic & Heavy Duty Roof Rack Systems

## SXBS6 Rhino Sportz - NISSAN Pathfinder

Place these instructions in the vehicle's glove box after installation is complete.

**Important:** Please read these instructions carefully prior to installation. Please refer to your fitting instruction to ensure that the roof racks are installed in the correct locations. Check the contents of kit before commencing fitment and report any discrepancies

### Parts List

Maximum carrying capacity: 80kg

Item	Component Name	Qty	Part No.
1	Sportz Rail Clamp Assembly	4	SXB-NIS
2	Sportz Rubber Buffer Strip	2	R011
3	SXB Sportz Cross bar	2	A045
4	Sportz Rail End Cap & Lock	4	C192, M076
5	Under Slot Cover Strip	1	R034
6	5mm Security Allen Key	1	SECKEY-L
7	Fitting Instruction	1	RS-98

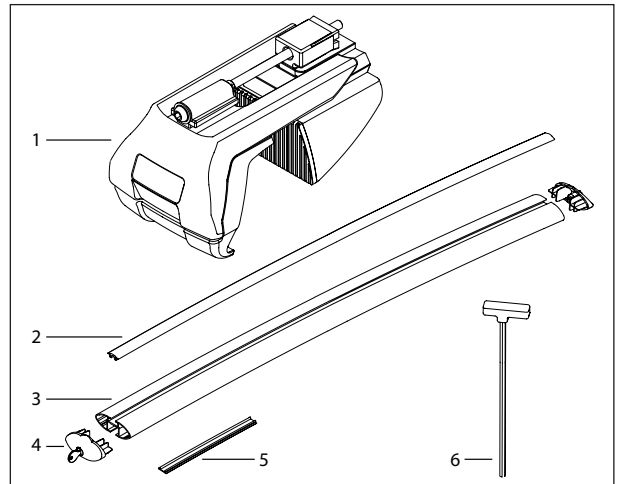

### Tools Required

Allen key, included in kit.  
T30 Torque Drive bit with screwdriver or a battery drill.  
Side Cutters.  
Tape Measure.

### IMPORTANT Care Instruction:

**Wash and clean the roof rails before fitting the Rhino Sportz Racks. PLEASE READ THROUGH INSTRUCTIONS BEFORE FITTING.**

### Layout

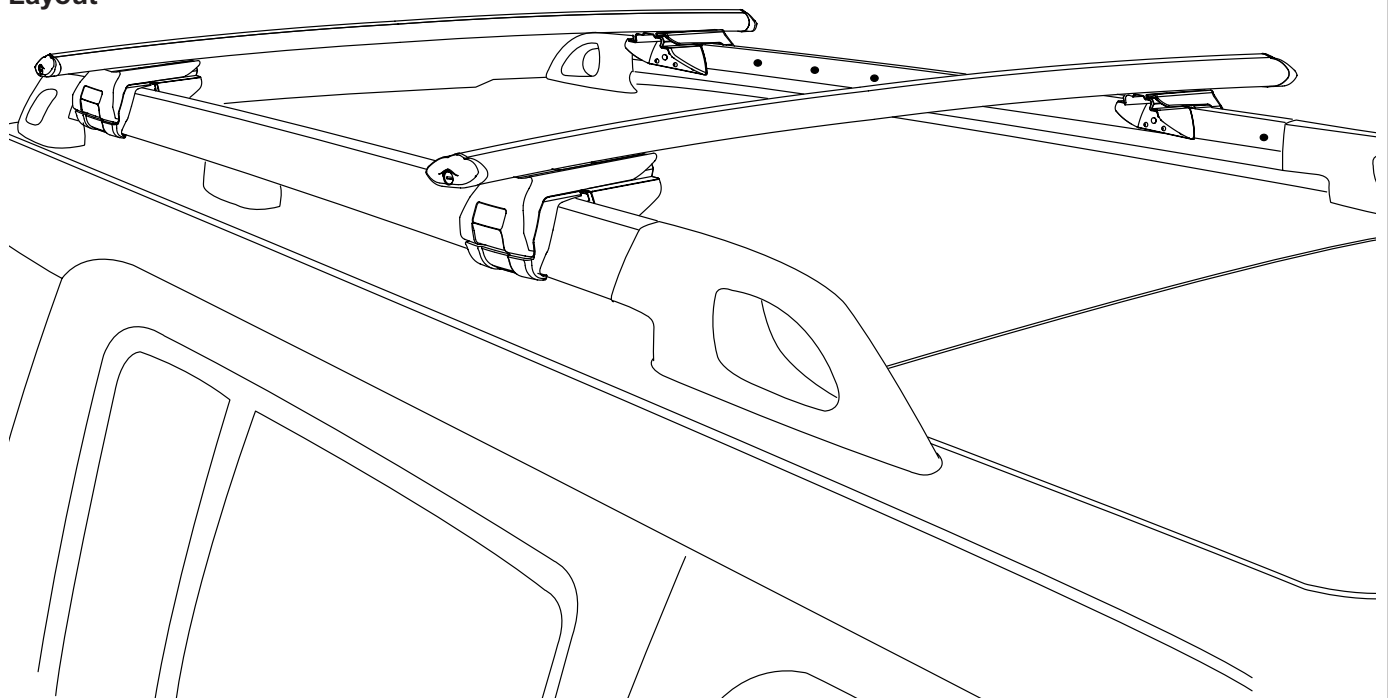



## SXBS6 Rhino Sportz - NISSAN Pathfinder

1

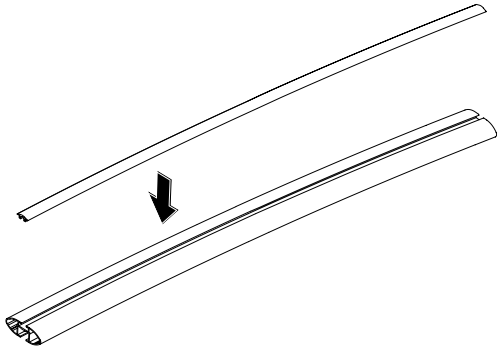

Press the rubber buffer strip into the top of the cross bar.

2

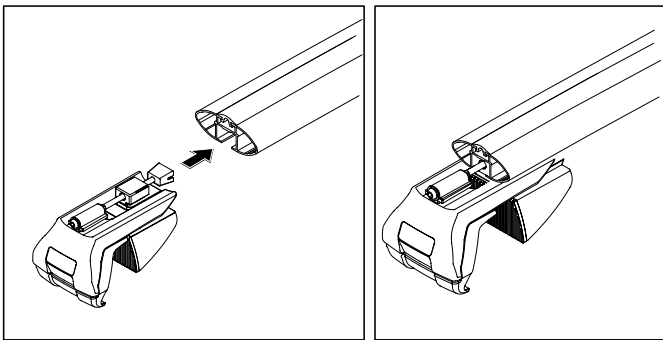

Slide each leg assembly into the end of the Sportz cross bar.

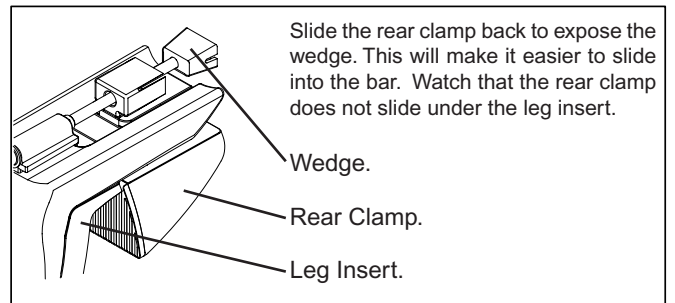

3

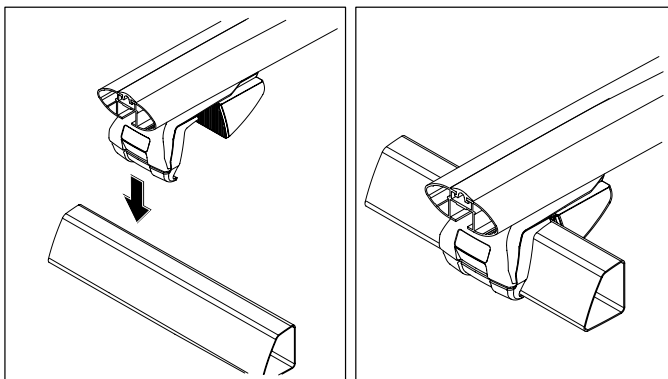

**Remove factory cross bars if fitted using a T30 Torque drive bit with screwdriver or battery drill.** If the vehicle has a sunroof, position the racks and your load so the sunroof is not obstructed when open. Line up between screws or use a tape measure to ensure the racks are parallel.

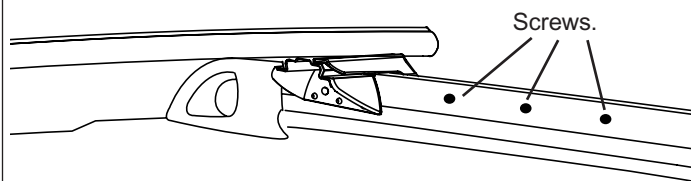

**IMPORTANT:** Avoid placing the clamps over the screws on the inside of the roof rails.

4

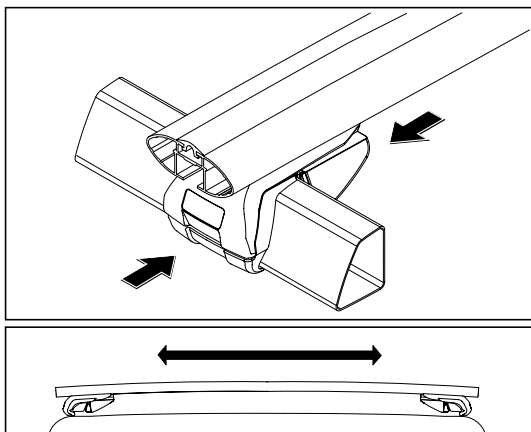

Pull the inner and outer clamp legs together around the rails. Adjust the Sportz cross bar so that the overhang is equal both sides. **Do not fully tighten as final tightening occurs later.**



## SXBS6 Rhino Sportz - NISSAN Pathfinder

5

EQUAL OVERHANG DISTANCE

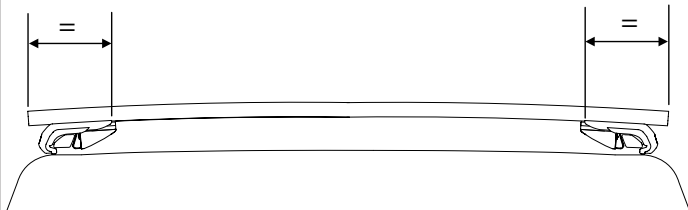

Use a tape measure to check the cross bar overhang is equal on both sides, re-adjust if required. Fully tighten the leg clamp bolts to 3-4Nm. **DO NOT OVERTIGHTEN.**

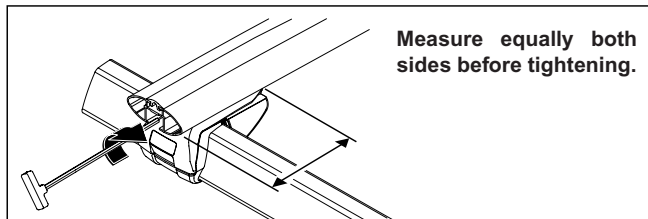

6

Once the leg assemblies are securely fitted, slide the under slot cover strip into the cross bar and use a pair of side cutters to cut flush with the edge of the cross bar.

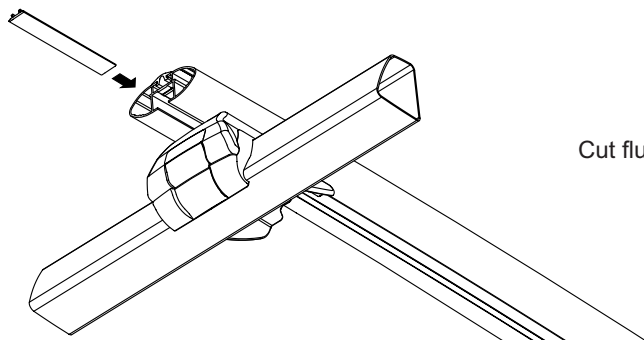

Cut flush with edge of cross bar.

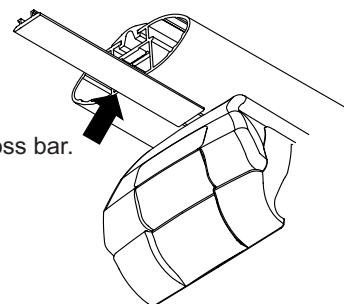

7

Before fitting the lockable end cap check that the locking tab is in the unlock position.

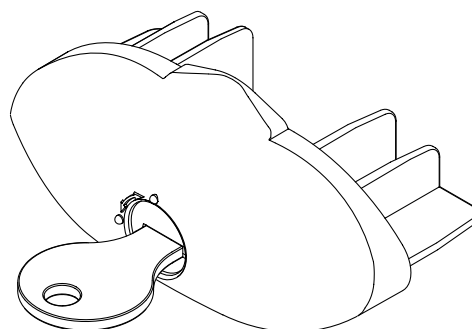
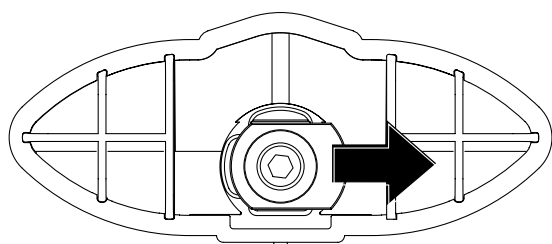

8

Insert the lockable end cap completely into the Sportz cross bar and turn the key to lock, remove the key.

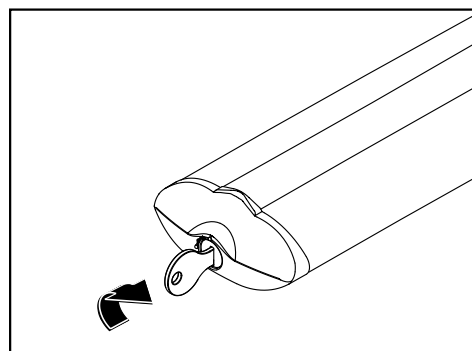
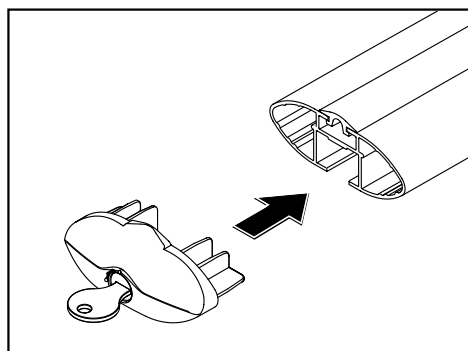



## SXBS6 Rhino Sportz - NISSAN Pathfinder

### Important Information

**Maximum carrying capacity: 80kg**

#### Recommendations

It is essential that all bolt connections be checked after driving a short distance when you first install your cross bars. Bolt connections should be checked again at regular intervals (probably once a week is enough, depending on road conditions, usage, loads and distances travelled). You should also check the cross bars each time they are refitted.

Make sure to fasten your load securely. Please ensure that all loads are evenly distributed and that the centre of gravity is kept as low as possible.

**Use only non-stretch fastening ropes or straps.**

#### Sensitivity to Cross winds, Behaviour in Curves and Braking

The handling characteristics of the vehicle, changes when you transport a load on the roof. For safety reasons, we recommend you exercise extreme care when transporting wind-resisting loads; special consideration must be taken into account when braking.

**Please remove cross bars when putting vehicle through an automatic car wash.**

#### Load Ratings

Maximum permissible load is 80kg per pair of cross bars (include the weight of the cross bars, 5kg). When roof racks are to be used in off-road conditions, please build a safety factor of 1.5 into this load limit. Although the cross bars are tested and approved to AS1235-2000, Australian road conditions can be much more rigorous. However, increasing the number of cross bars does not increase the vehicles maximum permissible roof loading.

#### Note for Dealers and Fitters

It is your responsibility to ensure instructions are given to the end user or client

Rhino-Rack  
3 Pike Street, Rydalmere,  
NSW 2116, Australia.  
(Ph) (02) 9638 4744  
(Fax) (02) 9638 4822

Document No: RS-98  
Prepared By: Craig Jones  
Authorised By: Gary England

Issue No: 02  
Issue Date: 25/08/2006

These instructions remain the property of Fetovu Pty Ltd T/as Rhino-Rack and may not be used or changed for any other purpose than intended.